

A.D.Coote Standard Rag Cage Installation Procedure

- 1) At A.D. Coote we design in-house rag cage footings to compliment our base plate mounted columns . These columns are installed on our rag cages once concrete in. These footings can be certified by an structural engineer who will require soil conditions for the pole location (A.D. Coote can assist with this if required). If you require specialised footings (e.g. pad footings or needle footings) A.D. Coote can also design, supply and have these footings certified.
- 2) Our rag cages come complete with one bolt template on the rag bolts which must be securely fitted prior to pouring the concrete for the footing (see Fig 1). This will ensure that the rag bolts will line up with the base plate. Failure to use a template will make it difficult to achieve the required bolt spacing and could result in the entire footing needing to be replaced.
- 3) Ensure all necessary conduit and any other services are fitted or allowed for in the footing prior to pouring of the concrete. Plus enough space needs to be allowed for the rag bolt protrusion for both nuts, washers ,the base plate, grouting and sufficient thread past the top nut.
- 4) Protect rag bolt threads from damage prior and during column erection.

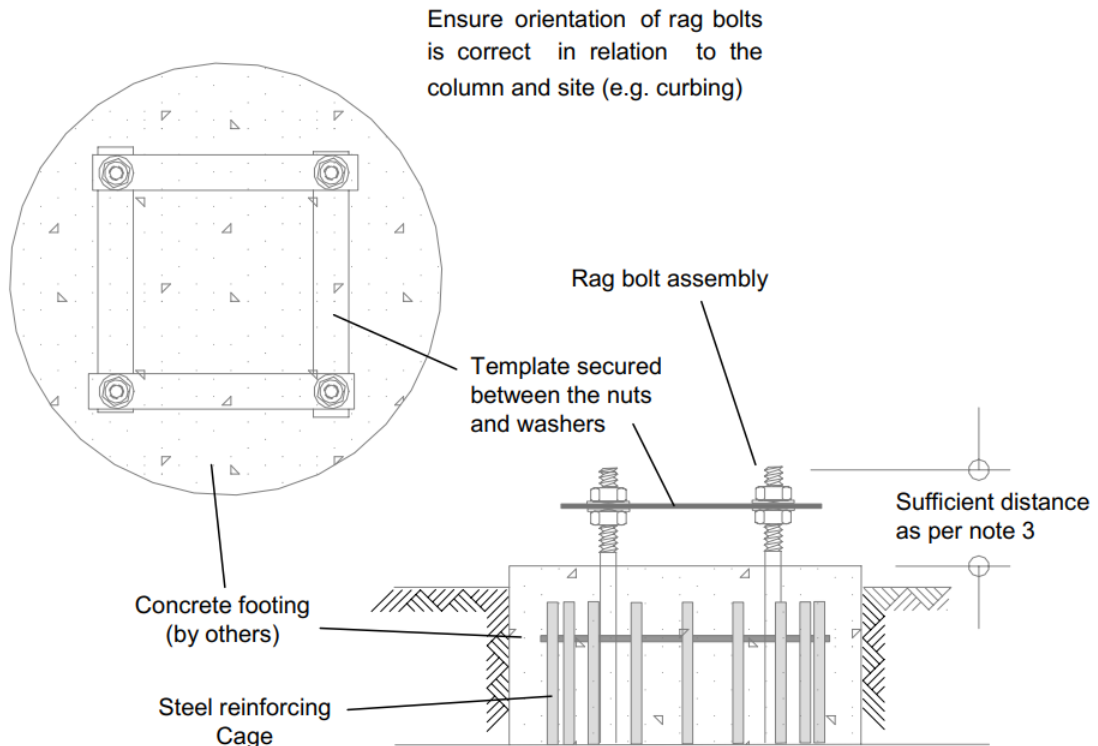

Fig 1



A.D. COOTE & CO.

THE METAL SPECIALISTS



t. (61) 8 9361 7666 | e. info@adcoote.com.au

w. adcoote.com.au | abn. 36 008 711 466

51-57 Welshpool Rd, WELSHPOOL, WA 6106

